

圖例 Legend

← 行車方向 Traffic Direction

✕✕✕✕ 火炭路支路往大埔公路-沙田段(南行)(九龍及荃灣方向)行車線 臨時封閉
Traffic lane temporary closure of the slip road from Fo Tai Road to Tai Po Road – Sha Tin (southbound) leading to Kowloon and Tsuen Wan direction

—▶—▶—▶ 火炭路(東行)右轉入大埔公路-沙田段(南行)往荃灣方向的車輛替代路線 – 經源禾路
Alternative route of right turn movement from Fo Tan Road (eastbound) to Tai Po Road - Sha Tin (southbound) leading to Tsuen Wan direction – via Yuen Wo Road

—▶—▶—▶ 火炭路(東行)右轉入大埔公路-沙田段(南行)往九龍方向的車輛替代路線 – 經大涌橋路
Alternative route of right turn movement from Fo Tan Road (eastbound) to Tai Po Road - Sha Tin (southbound) leading to Kowloon direction – via Tai Chung Kiu Road

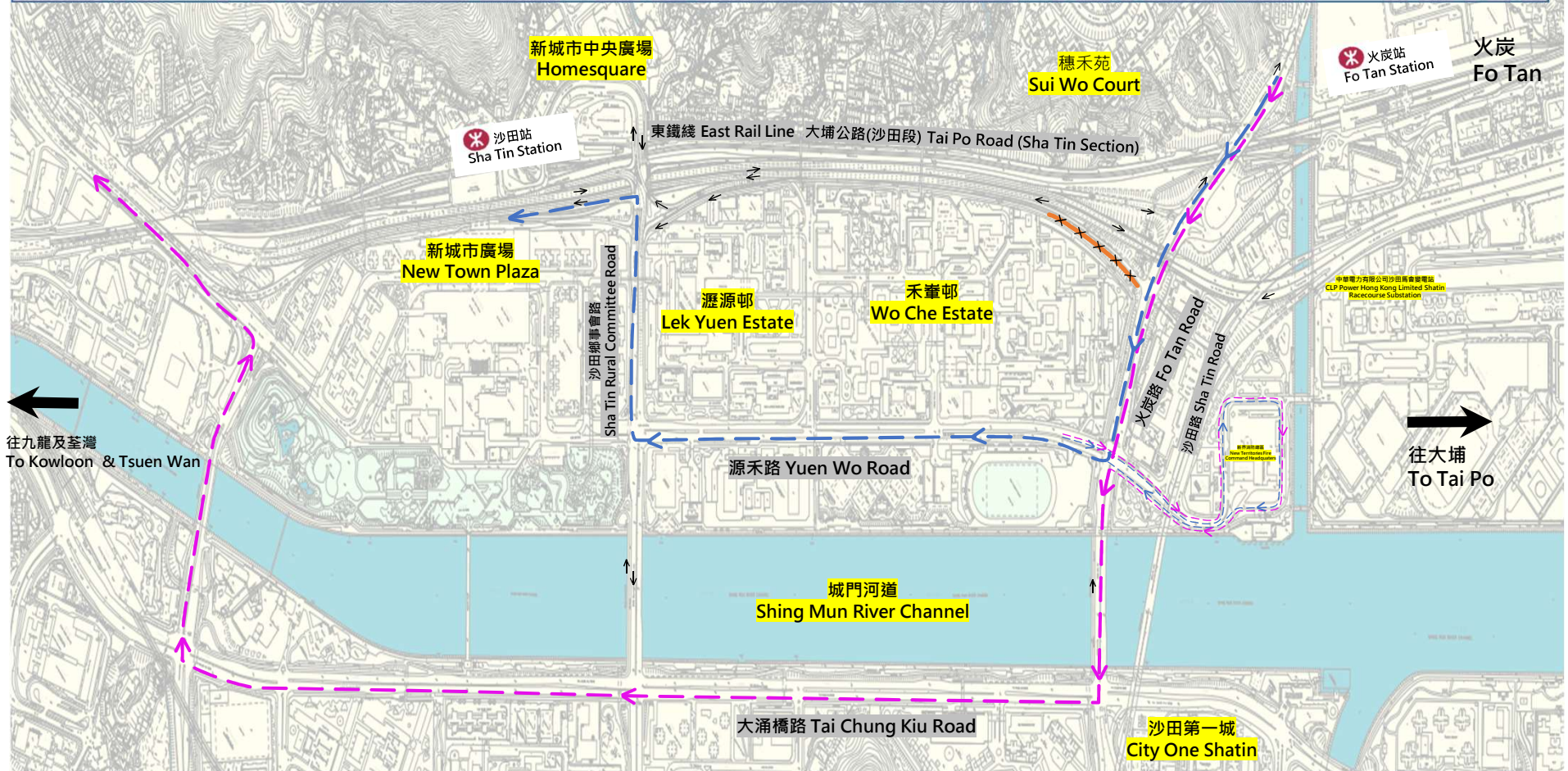

由火炭路支路往大埔公路 - 沙田段 (南行)往九龍及荃灣方向行車線 臨時封閉及替代路線
實施日期：2024年3月29日早上7時至 2024年4月1日早上6時

Temporary Closure of the Slip Road Leading from Fo Tan Road to Kowloon and Tsuen Wan Direction
of Tai Po Road – Sha Tin (Southbound) with Alternative Route
Implementation Period : 7:00 a.m. on 29 March 2024 to 6:00 a.m. on 1 April 2024

附圖
Figure